

# LED 25W & 70W LITEMOD

## Installation Instructions

For models: LEDPE25-41, LEDPE70-41, LEDPE70-64



**This installation must be carried out by an electrician.**

**Please read these instructions carefully before installation.**

**Leave a copy for the user/maintenance engineer for future reference.**

### Specification

- LED Panel
- Class I (must be earthed)
- Wattage: 25W, 70W
- Lamp (included): 121/360 SMD LED
- CRI: 80
- Beam Angle: 160°
- Supply voltage: 85-265V
- IP Rating: IP40
- Lumen Output: LEDPE25-64: 1700lm/s  
LEDPE70-41: 5700lm/s  
LEDPE70-64: 5900lm/s

- Connect the LED Panel input to the output of the power supply, connect the input of the power supply to the Mains. Brown - Live, Blue - Neutral, Yellow - Earth.
- Do not use the LED Driver supplied to power any other lamps or devices other than the LED Panel supplied.

### Important User Information

- Always switch off mains supply before servicing, fitting or maintenance.

### General Notice

- LED Panel light is for indoor use only.
- Before use, please confirm that the LED Panel is not damaged during shipping.
- Please keep all packing material away from children.
- Avoid looking directly into the LED light-emitting area.
- Do not cover products in any way. Ensure the panel is not exposed to naked flames, high temperature items, heaters etc.
- All electrical work installation & maintenance is carried out by a recognised electrician or professional.
- When cleaning the product ensure the LED Panel is switched off and a soft clean cloth is used to clean any debris away from the fitting. Please do not use any chemicals on this fitting.

### Important Installation Information

- Confirm all products are working before installation.
- There must be at least 100mm distance between the products and an inflammable material to ensure both high and low voltage electrical cables are separated.
- The wires behind the lamps can be secured with cable clips to ensure they are fixed securely.
- After installation, connect the input end of the lamp to the output end of the Switching Power Supply.

### Guarantee

This product is guaranteed for a period of 3 years from the date of purchase. The guarantee is invalid in the case of improper use, tampering, removal of the Q.C. date label, installation in an improper working environment or installation not according to the current edition of the I.E.E. Wiring Regulations (BS7671). The guarantee is also invalidated if the luminaire has been Mega tested. Should this product fail during the guarantee period it will be replaced free of charge, subject to correct installation and return of the faulty unit. We do not accept responsibility for any installation costs associated with the replacement of this product. We reserve the right to alter specifications without prior notice.



Product is suitable for mounting on flammable material



Product complies with all relevant European standards

# LED 25W & 70W LITEMOD

## Installation Instructions

For models: LEDPE25-41, LEDPE70-41, LEDPE70-64



### Installation Instructions for in-built (for a typical 600 x 600 LED Panel):

- 1. Remove ceiling tile. (as picture 1).
- 2. Connect the wire. (as picture 2).
- 3. Fit the Panel Light into the ceiling grid. (as picture 3).

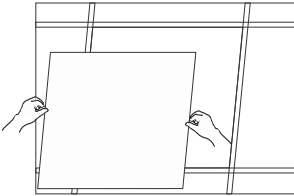

Picture 1.

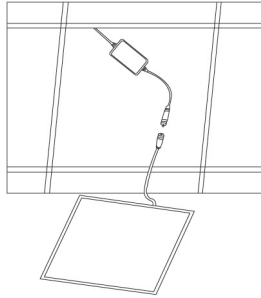

Picture 2.

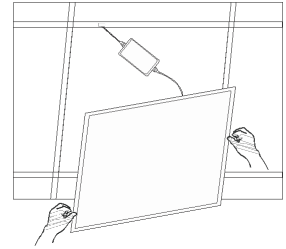

Picture 3.

- 4. After you have installed the panel light, you can connect the mains electric current to use. (as picture 4).

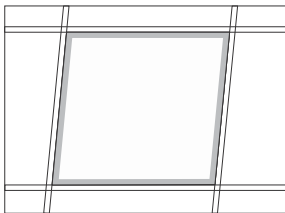

Picture 4.

### Installation Instructions for suspension type:

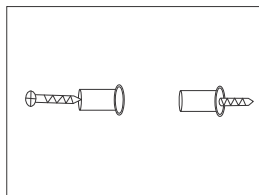

Picture 1.

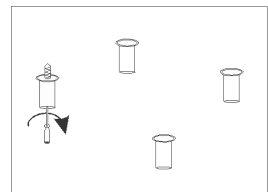

Picture 2.

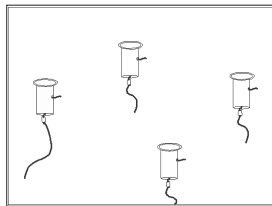

Picture 3.

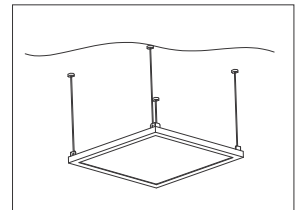

Picture 4.